

New!

1056 Series Couplings

Proven design, new sizes.



1056 Flexible Couplings

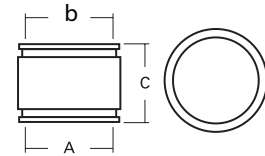

Part No.	Description	A		B		C	
		in	mm	in	mm	in	mm
1056-250	2 1/2" PL to 2 1/2" PL	2.88	73	2.88	73	3.50	89
*1056-250/22	2 1/2" PL to 2" CI, PL	2.88	73	2.38	60	3.50	89
*1056-250/150	2 1/2" PL to 1 1/2" CI, PL	2.88	73	1.90	48	3.50	89
*1056-250/125	2 1/2" PL to 1 1/4" PL	2.88	73	1.63	41	3.50	89
*1056-3/250	3" CI, PL to 2 1/2" PL	3.50	89	2.88	73	4.00	102



1056 Strong Back RC Couplings

Part No.	Description	A		B		C	
		in.	mm	in.	mm	in.	mm
1056-250RC	2 1/2" PL to 2 1/2" PL	2.88	73	2.88	73	3.50	89
*1056-250/22RC	2 1/2" PL to 2" CI, PL	2.88	73	2.38	60	3.50	89
*1056-250/150RC	2 1/2" PL to 1 1/2" CI, PL	2.88	73	1.90	48	3.50	89
*1056-250/125RC	2 1/2" PL to 1 1/4" PL	2.88	73	1.63	41	3.50	89
*1056-3/250RC	3" CI, PL to 2 1/2" PL	3.50	89	2.88	73	4.00	102

* Designated part numbers come with an insert bushing Other sizes available upon request



United States
 PH: 810-503-9000
 FX: 810-503-1015
 www.fernco.com

Canada
 PH: 519-332-6711
 FX: 519-332-8610
 www.fernco.ca