



300 S. DAYTON ST.
 DAVISON, MI 48423
 PH: 810-653-9626
 FAX: 810-654-2616

Part Number:
LDC 10 37.00x32.00

DESCRIPTION:
Custom Fabricated Coupling

HT Clamp Location (4)

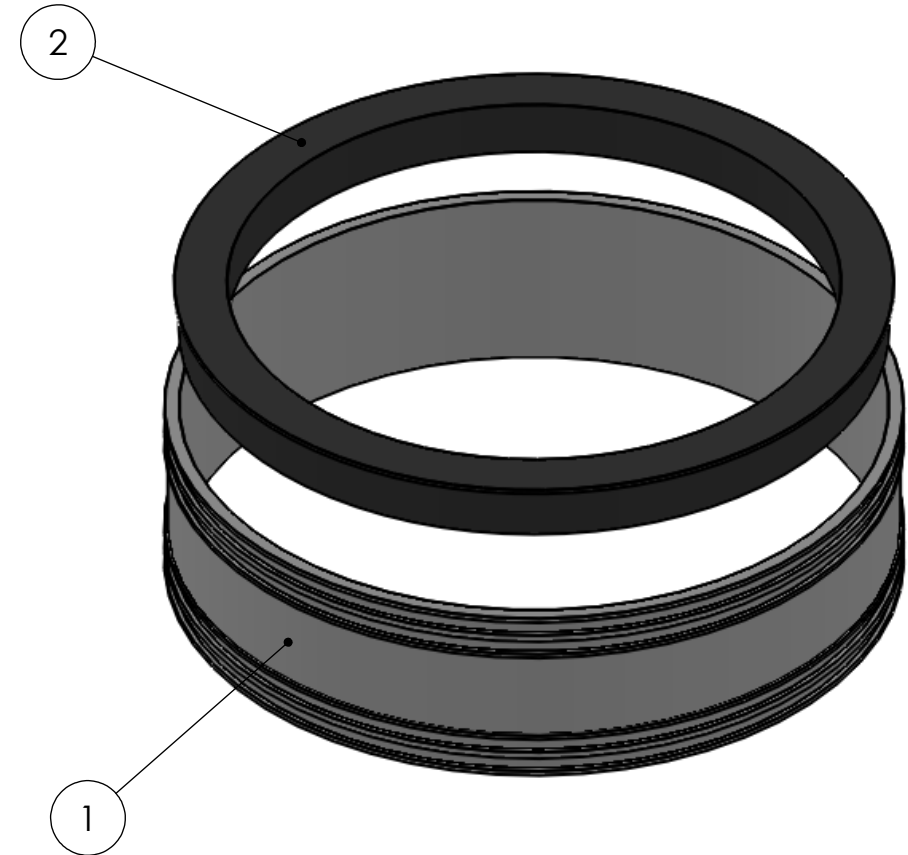
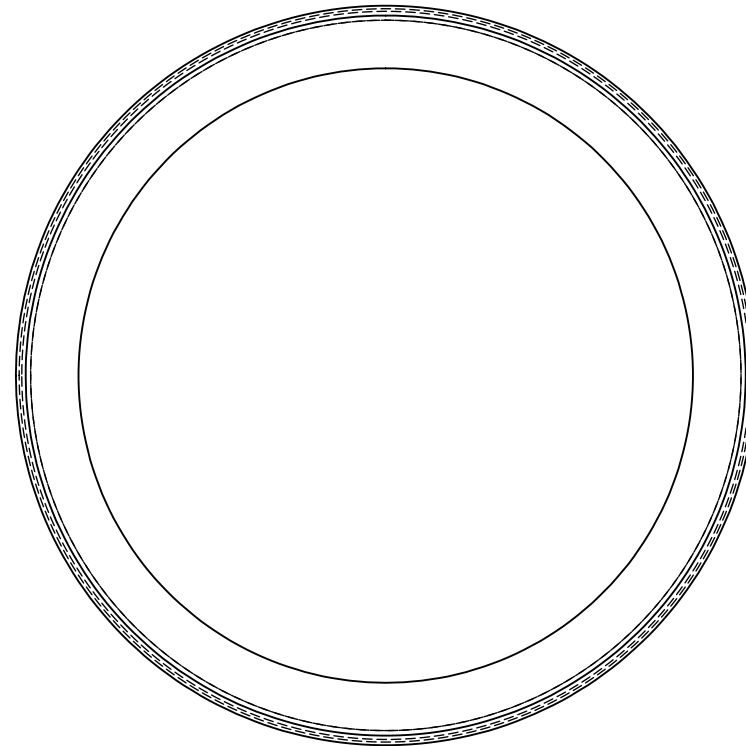
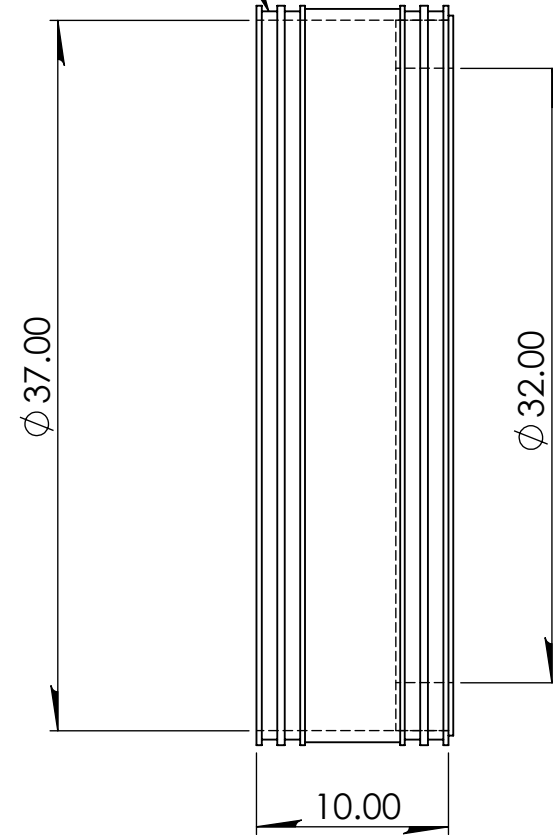

Note
 LDC Supplied with:
 300 SS High Torque Clamps

ITEM NO.	PART NUMBER	DESCRIPTION	QTY.
1	LDC 10 37.00	Custom welded LDC 10"	1
2	LDCR 2.50x32.00	Custom welded LDCR 2.50"	1

PROPRIETARY AND CONFIDENTIAL
 THE INFORMATION CONTAINED IN THIS
 DRAWING IS THE SOLE PROPERTY OF
 FERNICO, INC. ANY REPRODUCTION IN
 PART OR AS A WHOLE WITHOUT THE
 WRITTEN PERMISSION OF FERNICO, INC.
 IS PROHIBITED.

TOLERANCES:
 Fractional $\pm 1/4"$
 .XX = $\pm .06$
 ANG. = $\pm 3^\circ$
 UNLESS OTHERWISE SPECIFIED

Part Weight		Installation Torque	120 in lbs	UNITS:	SIZE:	DESIGNER:	SCALE:
Min/Max Temp.	-30/140 Degrees F	ASTM STANDARD	D5926, C1173	INCHES	A	T. Oistad	not to scale
Pressure Tested		Clamps used	300 Series Stainless	3RD ANGLE PROJECTION		CHECKER:	DATE:
Material	Flexible PVC 60 Duro Shore A	Box Quantity		DO NOT SCALE DRAWING			10/30/2015
							SHEET 1 OF 1